



**5CAS151T 34**  
150" x 17" x 73"

- Includes:
- 1 x 5CAS150T 34 TV Wall
  - 1 x 5CAS115 Door Vertical Insert
  - 2 x 5CAS415 Cross Shelf Insert
  - 1 x 5CAS230 2 Drawers Insert
  - 1 x 5CAS130 Door Horizontal Insert

Shown in #05 Matte Natural Teak with inserts in #901 Stone

# CASSIA Free Standing Wall Unit System



The modules are available in White Oak, Walnut or Teak veneer, in various finishes.

Book matching veneer selection for the complete wall unit.

The 60" TV panel comes with 1 shelf 8" deep and can receive up to a 60" flat screen TV (TV metal support needed). The shelves are constructed with a tongue & groove assembly to the 1" veneered back board reinforced with a steel structure to ensure strength and stability.

**Wire Management:**  
On the back TV panel at shelf, center and bottom levels are 4 partially predrilled holes called "soft spots".  
These holes can easily be opened with the provided tool.

The fully assembled 30" bookcase has 5 shelves 14" deep. The shelves are constructed with a tongue & groove assembly to the 1" veneered back board reinforced with a steel structure to ensure strength and stability.

Under each shelf of the bookcase, there are 2 concealed brass screw inserts to fix the chosen insert.

Wood strips are supplied to conceal the back metal frame at each extremity of the wall unit.

The inserts come fully assembled. Install them according to your design.

5 choices of inserts available in various colors.

Mounted on push to open soft-touch full extension self-closing slides.

**Assembly:**  
Starting from the left, or from the right, the modules are attached one by one using specific hardware. During assembly the shelves will align to each other. Once all units are attached, completed wall unit can be rolled in place.

The bookcase and the TV unit are built on wheels to ease assembly before setting in place and leveling.

To adjust the levelers, remove the 2 bottom drawers of the TV unit, you will then have access to all levelers. The unit has 5 levelers.

The TV stand has 2 drop glass doors to hide the electronic components and an open back for ventilation and wire management. At the bottom of the unit are 2 drawers mounted on push to open soft-touch full extension self-closing slides.

To adjust the levelers, remove the bottom shelf of the bookcase you will then have access to all levelers. Each bookcase has 4 levelers.

**Wire Management:**  
On the back panel at every shelf level are 2 partially predrilled holes called "soft spots". These holes can easily be opened with the provided tool.

The "soft spots" are located at 7 1/2" from each side of bookcase and 2 1/2" above the shelf.

Doors mounted on push to open hardware.

The insert 5CAS115 can be installed with right or left door opening. Doors mounted on push to open hardware.

## Bookcases & TV Walls



**5CAS030**  
30" Bookcase  
30" x 17" x 73"



**5CAS060**  
60" Bookcase  
60" x 17" x 73"

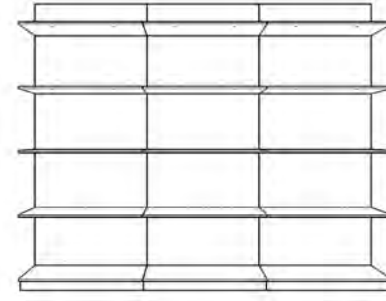

**5CAS090**  
90" Bookcase  
90" x 17" x 73"

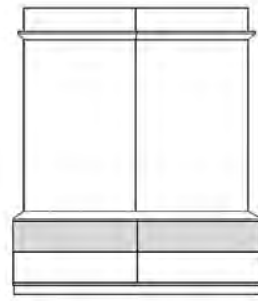

**5CAS060T**  
60" TV Bookcase  
60" x 17" x 73"

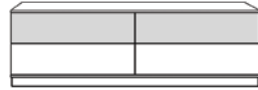

**5CAS560**  
60" TV Unit  
60" x 17" x 18"

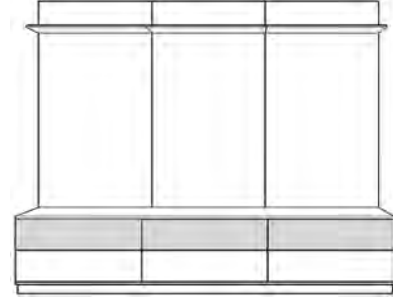

**5CAS090T**  
90" TV Bookcase  
90" x 17" x 73"

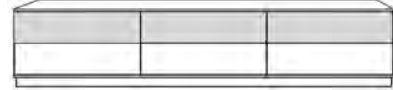

**5CAS590**  
90" TV Unit  
90" x 17" x 18"

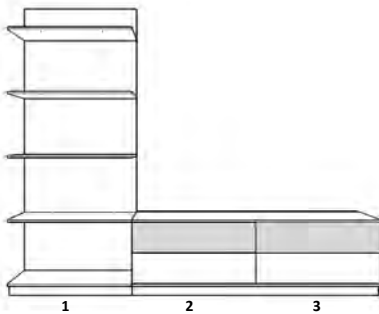

**5CAS590 23**  
TV Wall 90"  
90" x 17" x 73"  
The number "23" indicates the TV unit position in the 5CAS590 wall.

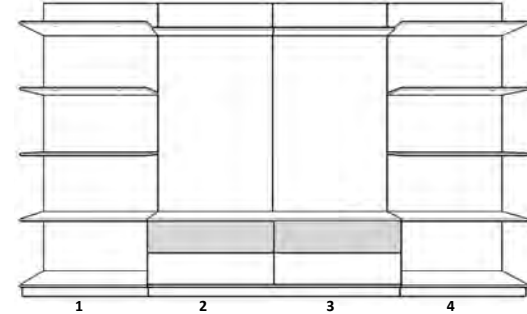

**5CAS120T 23**  
TV Wall 120"  
120" x 17" x 73"  
The number "23" indicates the TV bookcase position in the 5CAS120T wall.

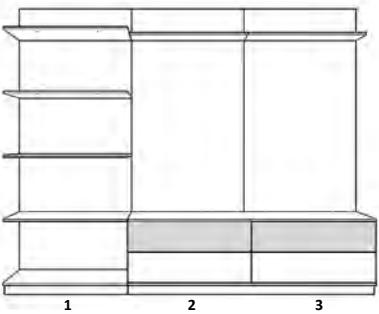

**5CAS090T 23**  
TV Wall 90"  
90" x 17" x 73"  
The number "23" indicates the TV bookcase position in the 5CAS090T wall.

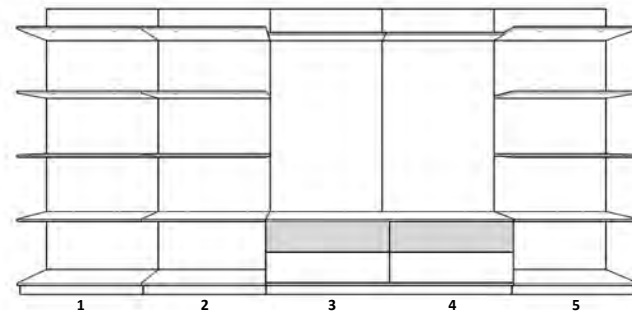

**5CAS150T 34**  
TV Wall 150"  
150" x 17" x 73"  
The number "34" indicates the TV bookcase position in the 5CAS150T wall.

## Inserts

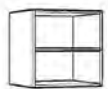

**5CAS015**  
Open Shelf  
15" x 13 1/4" x 15"

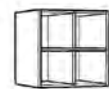

**5CAS415**  
Cross Shelf  
15" x 13 1/4" x 15"

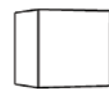

**5CAS115**  
Door Vertical  
15" x 14" x 15"

Can be installed with right or left door opening. Doors mounted on push to open hardware.

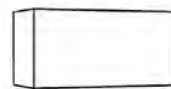

**5CAS130**  
Door Horizontal  
30" x 14" x 15"

Doors mounted on push to open hardware.

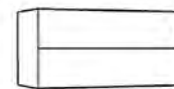

**5CAS230**  
2 Drawers  
30" x 14" x 15"

Mounted on push to open soft-touch full extension self-closing slides.

## How to order

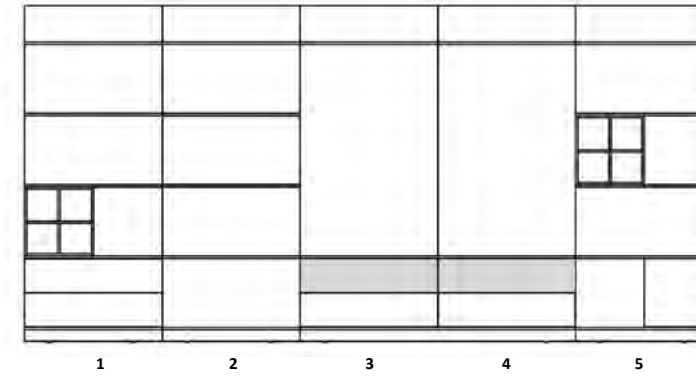

1. Size needed
2. Select the bookcase/ TV walls configuration or create your own configuration.
3. Indicate position of the TV bookcase in the wall unit.
4. Select desired inserts
5. Choose wood specie and finish of your wall unit. Refer to the price list for available finishes.
6. Choose the inserts colors.



### Example:

1. Size: 150"
2. Configuration: 5CAS150T
3. TV position: 34
4. Inserts: 2 x 5CAS415 Cross Shelf  
1 x 5CAS115 Door Vertical  
1 x 5CAS130 Door Horizontal  
1 x 5CAS230 2 drawers
5. #05 Matte Teak Natural
6. #901 Stone

## Design your CASSIA Wall Unit

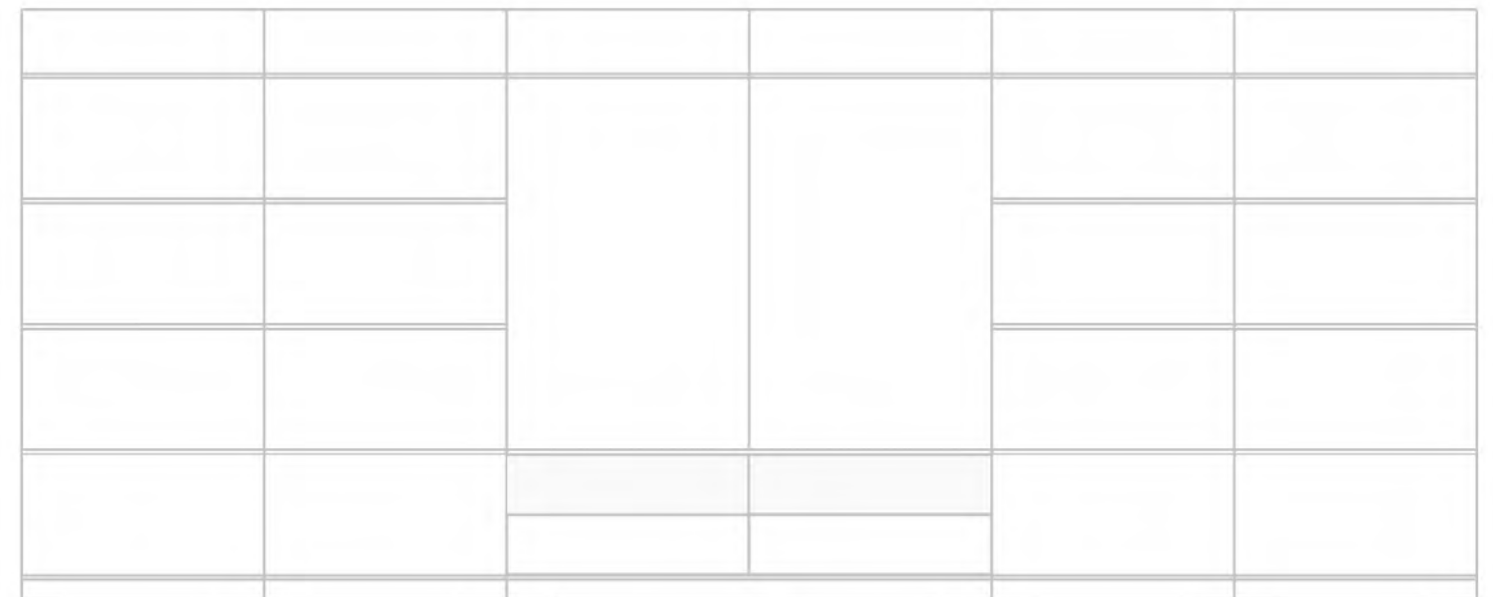

1. Size:
2. Configuration:
3. TV position:
4. Inserts:
5. Wood Finish:
6. Inserts Color: